

Thermometer

type SC15 with capillary and micro switch
panel mounting

E 10.24.02

Ed.17.01

| | |
|---------------------------|---|
| Design | Expansion thermometer with capillary and micro switch for panelmounting in standard design |
| Type | SC15 |
| Accuracy | Cl. 2,0% |
| Case dim | Dim 60, 80, or 100 Special option dim 72x72 or 96x96 mm |
| Hus | Black plastic case with panel frame and clamp Chromated steel case with panel ring and clamp Black plastic case with panel ring and clamp Black plastic case with spring clips Also plastic case in white or grey |
| Scale range | Scale range min -100°C, max 400°C Unit Celsius °C or Celsius + Fahrenheit °C+°F |
| Dial | Dial of plastic or aluminium White background with black figures Black background with white figures Option with customer logo or coloured sectors |
| Mounting | Panel mounting with clamp or spring clips |
| Glass | Instrumentglass or plexiglass |
| Measuring system | Expansion type, filling Xylol |
| Capillary | Plastic coated (temperature max 120°C) Copper braided (temperature max 350°C) Stainless steel (temperature max 400°C) |
| Capillary length | Max 5 meter capillary |
| Stem | Immersion stem of brass or stainless steel Dim Ø 5, 6, 8, 8,5 or 10 mm |
| Stem length | Immersion length ET 40-200 mm |
| Connection | G1/4", G3/8", G1/2", G3/4", M12x1,5 |
| Type of connection | Rotable connection with thermowell Plain stem without connection Male nut with connection nipple Male nut with thermowell Union nut Compression fitting male |
| Micro switch | Micro switch to be set all over the scale 5 A non-inductive 250VAC 40-60Hz Hysteresis 2% of scale range Electrical connection terminalblock or AMP plug |
| Type av contact | 1 adjustable change over switch 2 adjustable change over switches 1 fixed change over switch 2 fixed change over switches 1 adjustable and 1 fixed change over switches |



Chromated steel case
with panel ring and clamp
1 adjustable change over switch
Plastic coated capillary
Rotable connection with thermowell
of brass L-45 mm G1/2"



Black plastic case
with panel frame and clamp
1 adjustable change over switch
Plastic coated capillary
Plain stem without connection

Thermometer

type SC15 with capillary and micro switch
panel mounting

E 10.24.02

| Measuring range | | | |
|-----------------|------------|-------------|--------------|
| -40 + 60°C | -20 + 60°C | -10 + 50°C | -30 + 50°C |
| -40 + 40°C | 0 + 60°C | 0 + 80°C | 0 + 100°C |
| 0 + 120°C | 0 + 160°C | 0 + 200°C | +50 + 200°C |
| 0 + 250°C | 0 + 300°C | +50 + 300°C | 0 + 350°C |
| +50 + 350°C | 0 + 400°C | +50 + 400°C | +100 + 400°C |

All measuring ranges can be delivered with double unit Celsius + Fahrenheit °C+°F

Standard design SC1560

Chromated steel case dim 60 mm with panel ring and clamp
1 adjustable change over switch. 5 A non-inductive 250VAC 40-60Hz
Plastic coated capillary. Rotable connection with thermowell SB18 of brass
Immersion length L-45 mm G1/2"

| Type | Range | Capillary | Length | Code |
|--------|---------|-----------|---------------|----------|
| SC1560 | 0+120°C | 3 meter | L-45 mm G1/2" | 30600739 |

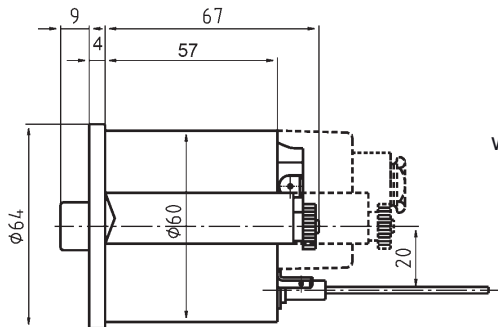

SC1560 dim 60 mm
1 switch
Chromated steel case
with panel ring and clamp

Thermometer

type SC15 with capillary and micro switch
panel mounting

E 10.24.02

Thermometer case

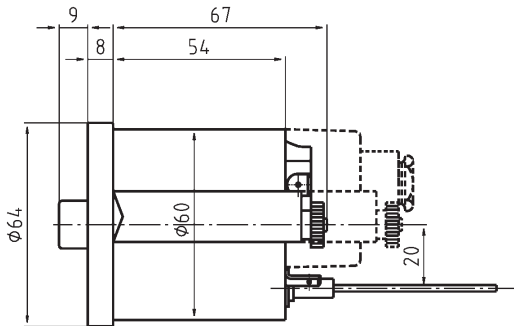

SC1560 dim 60 mm
1 switch
Black plastic case
with panel frame and clamp

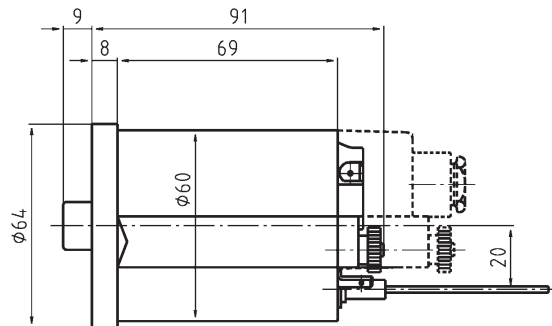

SC1560 dim 60 mm
2 switches
Black plastic case
with panel frame and clamp

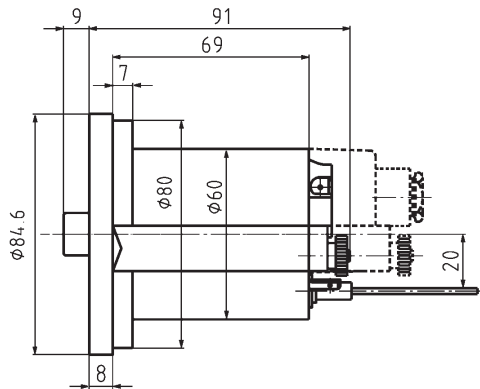

SC1580 dim 80 mm
1 or 2 switches
Black plastic case
with panel frame and clamp

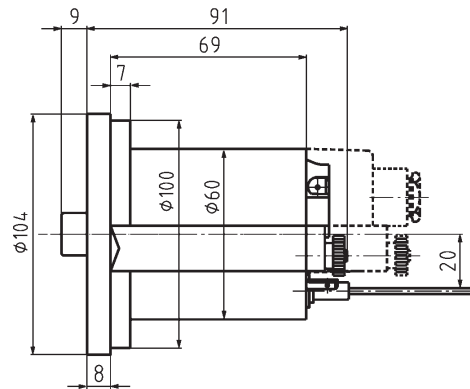

SC1510 dim 100 mm
1 or 2 switches
Black plastic case
with panel frame and clamp

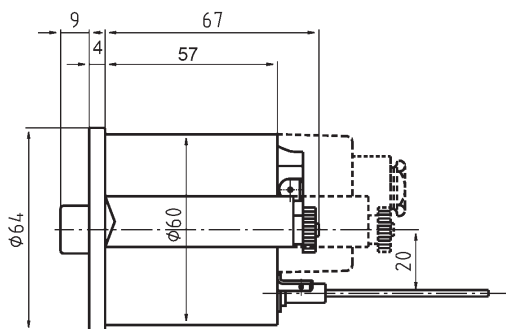

SC1560 dim 60 mm
1 switch
Chromated steel case
with panel ring and clamp

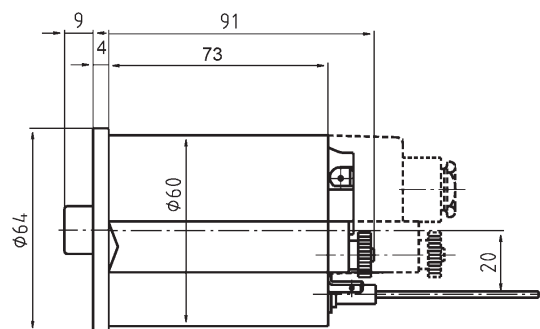





SC1560 dim 60 mm
2 switches
Chromated steel case
with panel ring and clamp

Thermometer

type SC15 with capillary and micro switch
panel mounting

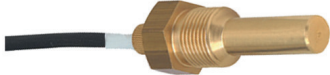
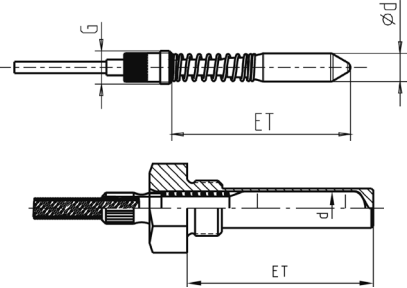
E 10.24.02

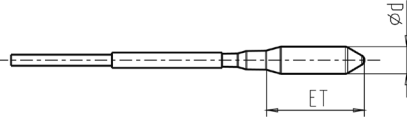
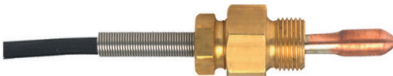
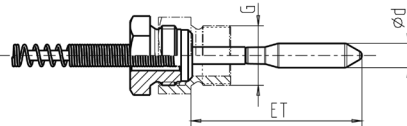
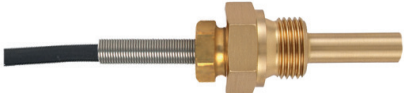
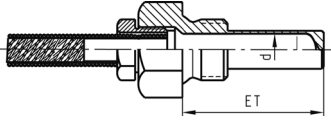
Connection type

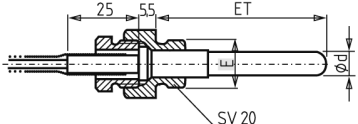
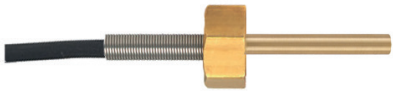
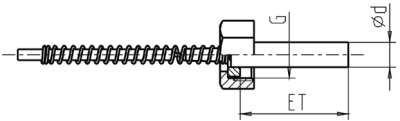
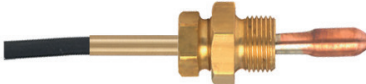
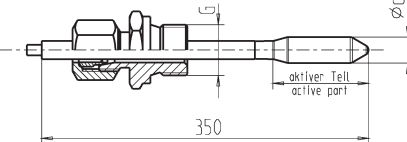
| | | |
|---|--|---|
| <p>Connection SF95/SB18 Rotable connection M10x1 mm Stem dim \varnothing 8,5 mm With thermowell SB18 G3/8", G1/2" Stem length ET 29, 32, 45, 75, 100 mm Material brass or stainless steel</p> |  |  |
| <p>Connection SF94 Plain stem without connection Stem dim \varnothing 6, 8, 8,5 or 10 mm Stem length ET 40-200 mm Material brass or stainless steel</p> |  |  |
| <p>Connection SF91/SV20 Male nut G1/4", G3/8", G1/2" Stem dim \varnothing 5, 6, 8, 8,5 or 10 mm With nipple SV20 G1/4", G3/8", G1/2" Stem length ET 40-150 mm Material brass or stainless steel</p> |  |  |
| <p>Connection SF91/SH16 Male nut G1/4", G3/8", G1/2" Stem dim \varnothing 5, 6, 8, 8,5 or 10 mm With thermowell SH16 G3/8", G1/2" Stem length ET 40-150 mm Material brass or stainless steel</p> |  |  |
| <p>Connection SF91/SV19 Male nut G3/8", G1/2" Stem dim \varnothing 5, 6, 8, 8,5 or 10 mm With nipple SV19 G3/8", G1/2" Stem length ET 40-200 mm Material brass or stainless steel</p> |  |  |
| <p>Connection SF97 Union nut G3/8", G1/2", G3/4" Stem dim \varnothing 6, 8 or 10 mm Stem length ET 40-200 mm Material brass or stainless steel</p> |  |  |
| <p>Connection SF98 Compression fitting G1/4", G3/8", G1/2" Stem dim \varnothing 6 mm, bulb 8,5 mm Stem length ET 40-200 mm Material brass or stainless steel</p> |  |  |